

# Daytona

## LFPP9 9,000 LBS 4-POST PARKING LIFT



### Features

- Four mechanical locking devices, each equipped with both primary and secondary safety locks
- Single point manual safety release
- Removable tilting Aluminum approach ramp
- Large heavy duty 3" cylinder
- Aircraft quality lifting cables
- Matted powder coat finish
- Adjustable runways
- Pump can be mounted on any post



LFPP9

*Note: Product may vary slightly from image shown*

**Please Note: Optional Rolling Jacks and Wheel Kits are sold separately. Our 9,000lb Parking lift comes with 1 steel tool tray and 3 plastic drip trays**

# Daytona

## LFPP9 9,000 LBS 4-POST PARKING LIFT

### Specifications

Power - 120V 1.5HP 26Amp 1 PH 60Hz

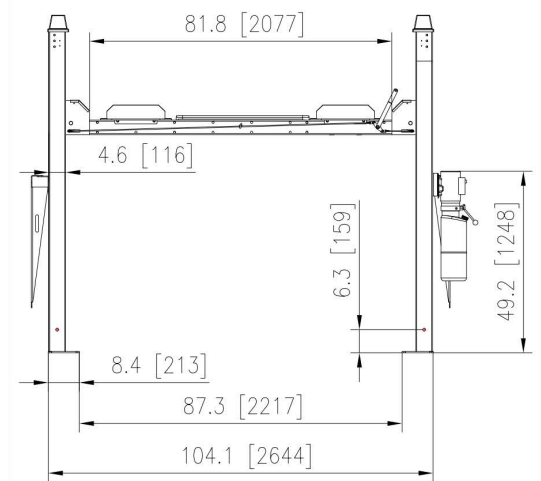
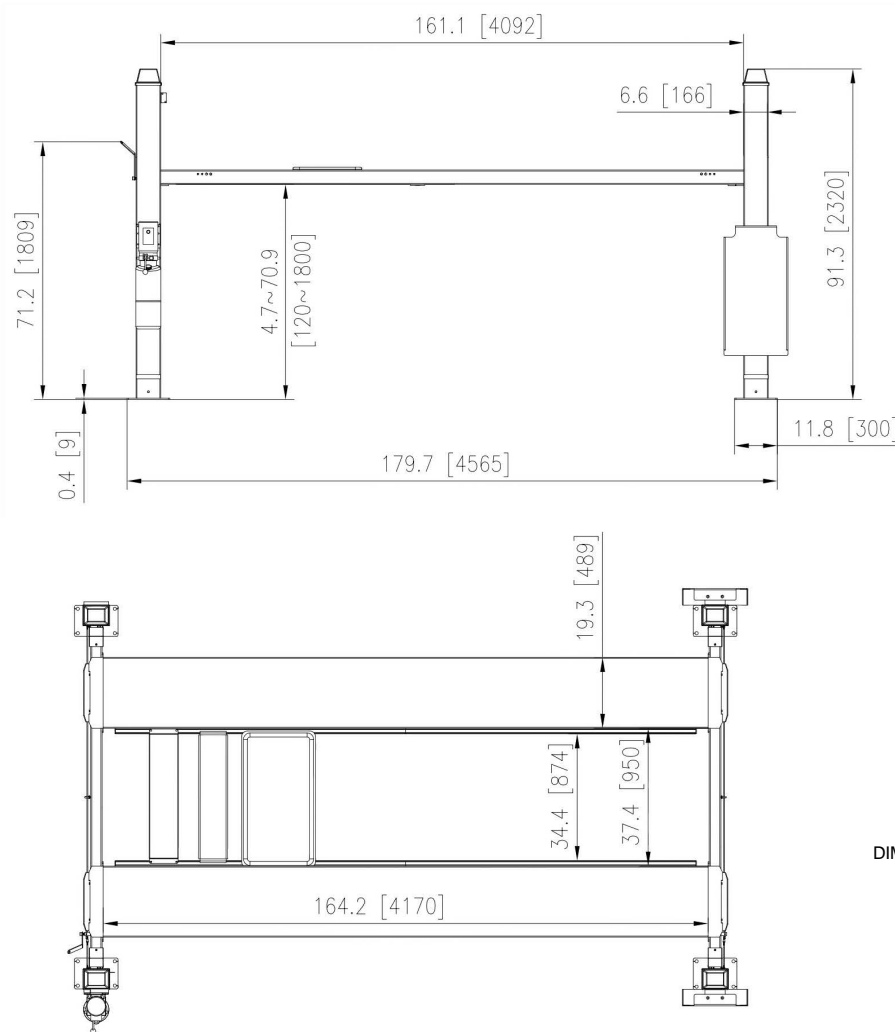

DIMENSIONS, COLOURS AND ITEMS ARE SUBJECT TO CHANGE WITHOUT PRIOR NOTICE DUE TO OUR CONTINUOUS IMPROVEMENT PROGRAM

Shipping Dimensions: Lift 175" x 23" x 30" 1800lbs  
Pump attached to lift. Included in dimensions  
Optional Wheel Kit 40" x 24" x 10" 120lbs

101 Applewood Dr Brighton ON K0K1H0  
1-866-219-9991 / 613-475-5400  
CustomerCare@daytonaproducts.com  
[www.DaytonaProducts.com](http://www.DaytonaProducts.com)