

Daytona

LFPA12 **12,000 LBS 4-POST** **ALIGNMENT LIFT**



LFPA12

Note: Product may vary slightly from image shown



Features

- Ladder lock system with manual release has locking positions every 3.5" starting at 21"
- Tilting approach ramps in bright orange
- Large heavy duty 5" cylinder
- Aircraft quality lifting cables
- Matted powder coat finish in dark Grey
- Built in slip plates and adjustable turntables
- 25.5" runway accommodates various vehicle widths
- Will accommodate most dual rear wheel pickup trucks

Please Note: Lift only - Wheel Alignment Machine is sold separately. Rolling Jack is sold separately.

Daytona

LFPA12

12,000 LBS 4-POST ALIGNMENT LIFT

Specifications

Power - 240V 4 HP 15 Amp 1PH 60Hz

Rise Time - 110s

Drop Time - 110s

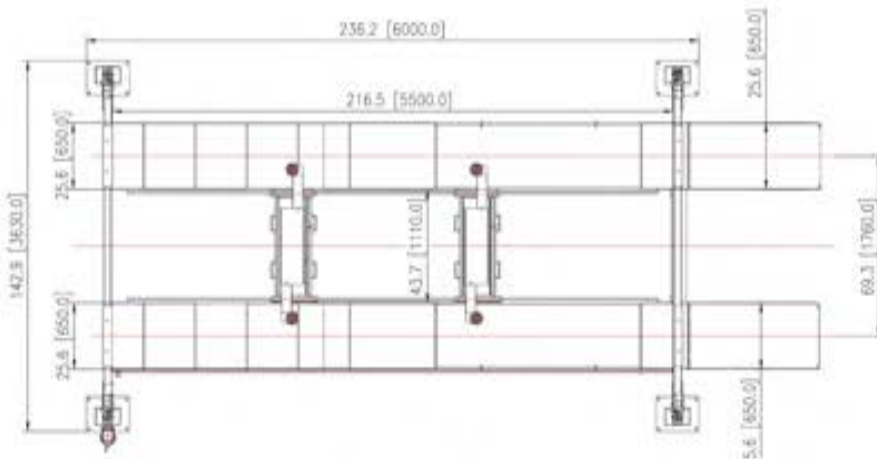
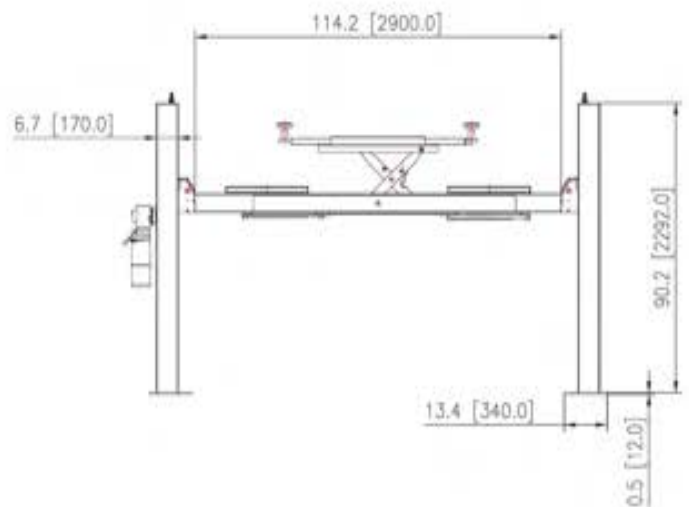
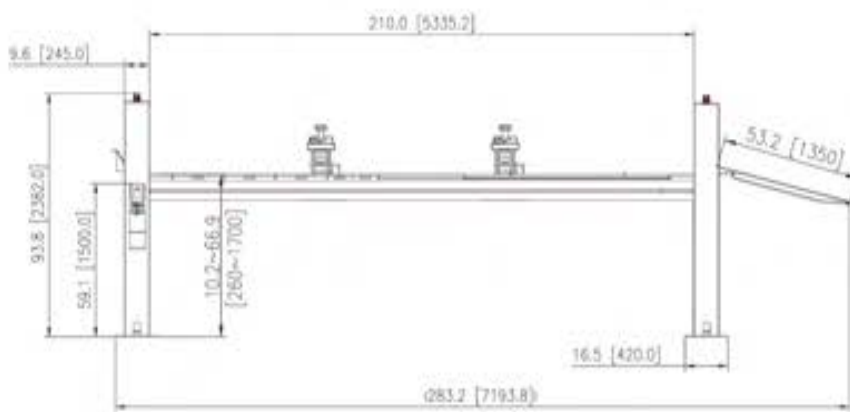

DIMENSIONS, COLOURS AND ITEMS ARE SUBJECT TO CHANGE WITHOUT PRIOR NOTICE DUE TO OUR CONTINUOUS IMPROVEMENT PROGRAM

Shipping Dimensions: Lift 229" x 30" x 44" 4500lbs
Pump attached to lift. Included in dimensions

101 Applewood Dr Brighton ON K0K1H0
1-866-219-9991 / 613-475-5400
CustomerCare@daytonaproducts.com
www.DaytonaProducts.com